

Getting
Electricity
Where It's
Needed



TODAY



FUTURE



We are **working with the community** to design the substation enclosure while meeting all security and safety standards.

**Property Transfers
with the city**
2009 -> 2011 -> 2018



Environmental Cleanup
2019

Focus Group Meeting
October 25th, 2021

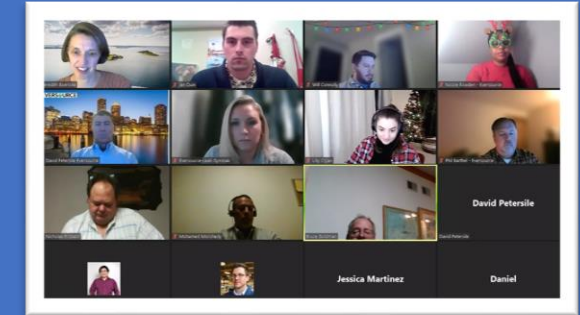

Focus Group Meeting
December 13th, 2021



EFSB (state) Approval
December 2017

EFSB (state) Approval
February 2021

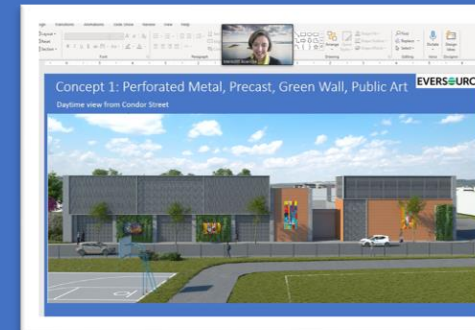

Focus Group Meeting
November 15th, 2021

"Open Houses"
Aug. 23 and 25, 2022



Community Benefits from Eversource



Environment

Improved the soil by removing 10,000 tons of contaminated soil from the site



Open Space

\$600,000 for things like trees, lighting, trash cans, and benches for the Urban Wild
\$400,000 to increase the tree canopy in Eagle Hill and East Boston



Recreation

\$175,000 for things like new trees, lighting, and fresh paint at the American Legion Playground



Green Energy

\$250,000 for the Boys & Girls Club to make the building more comfortable and energy efficient



Energy Efficiency for Small Businesses

Personal attention for business owners to take advantage of energy-saving solutions to save money



GREEN WALL

All potential designs incorporate a “living wall”

Note: These are design concepts only. The final design will be chosen in collaboration with the community, the BPDA, and the Company. These are concept photos only.



PUBLIC ART

All potential designs incorporate public art from local artists

Note: These are design concepts only. The final design will be chosen in collaboration with the community, the BPDA, and the Company. These are concept photos only.

Proposed Substation Enclosure Designs

View from American Legion Playground

A Translucent



B Perforated



C Terra Cotta



View facing south

A Translucent



B Perforated



C Terra Cotta



View from Urban Wild

A Translucent



C Terra Cotta



B Perforated



*Note: this side of the façade is the same for both concepts A and C based on feedback from the Focus Group about the originally proposed Urban Wild façade for concept A.

Evening view from American Legion Playground

In these designs, the lighting is customizable and will be controlled by the city



A Translucent



B Perforated



C Terra Cotta

Note Design Option C: Terra Cotta does not have a backlit component.

A Translucent



B Perforated



C Terra Cotta



Tell us which design you think is best for the Eagle Hill neighborhood

Next Steps

- ✓ Reconvene the Focus Group to confirm the final design based on the feedback from the neighborhood open houses

Our Design Process

Focus Group

STEP
1

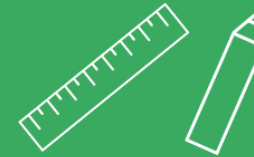

STEP
2

Revised
Renderings

Focus Group

STEP
3



STEP
4

Community
Open House

Focus Group

STEP
5

